

**Bearing No. BTM4530**

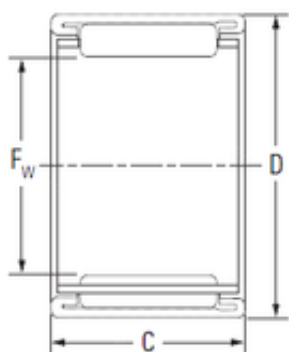

D	52 mm
C	30 mm
Fw	45 mm
Weight	0,12 Kg
Size (mm)	45x52x30
Width (mm)	30
Bearing number	BTM4530
Bore Diameter (mm)	45
Outer Diameter (mm)	52
Basic dynamic load rating (C)	45,3 kN
Basic static load rating (C0)	91,7 kN