

Bearing No. BTM5015

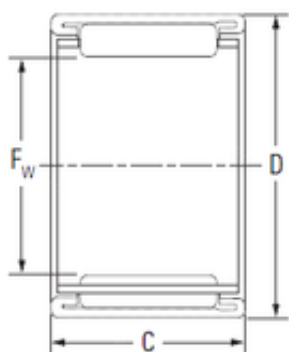

D	62 mm
C	15 mm
Fw	50 mm
Weight	0,073 Kg
Size (mm)	50x62x15
Width (mm)	15
Bearing number	BTM5015
Bore Diameter (mm)	50
Outer Diameter (mm)	62
Basic dynamic load rating (C)	24,3 kN
Basic static load rating (C0)	36,4 kN