

Bearing No. BTM5020

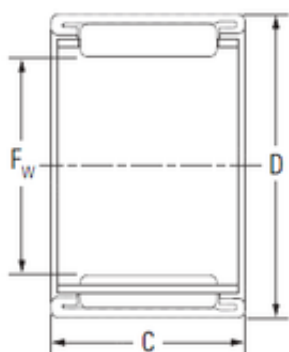

D	62 mm
C	20 mm
Fw	50 mm
Weight	0,099 Kg
Size (mm)	50x62x20
Width (mm)	20
Bearing number	BTM5020
Bore Diameter (mm)	50
Outer Diameter (mm)	62
Basic dynamic load rating (C)	34,5 kN
Basic static load rating (C0)	57,1 kN