

Bearing No. BTM667216J

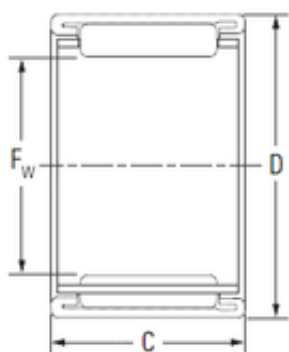

D	72 mm
C	16 mm
Fw	66 mm
Weight	0,054 Kg
Size (mm)	66x72x16
Width (mm)	16
Bearing number	BTM667216J
Bore Diameter (mm)	66
Outer Diameter (mm)	72
Basic dynamic load rating (C)	21,9 kN
Basic static load rating (C0)	61,1 kN