

### Bearing No. RCJ15/16

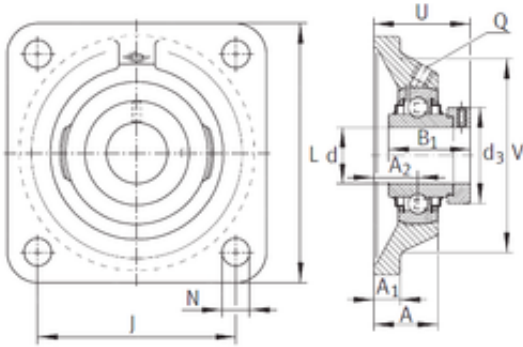

d	23,813 mm
V	80,01 mm
U	45,999 mm
A	30,505 mm
B	44,501 mm
J	70,002 mm
L	95,504 mm
N	11,506 mm
d3	37,49 mm
A1	13,005 mm
A2	18,999 mm
Thread (Q)	1/8 NPT
Bearing number	RCJ15/16
Bore Diameter (mm)	23,813