

### Bearing No. MBT10

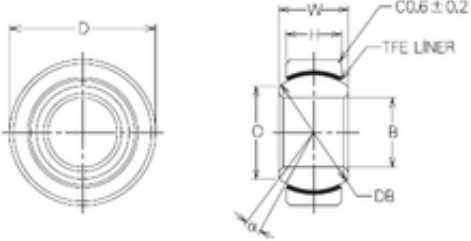

C	8 mm
W	10 mm
d	10 mm
D	21 mm
B	10 mm
O	13,3 mm
H	8 mm
Db	16,669 mm
Angle	8 °
Weight	0,019 Kg
Size (mm)	10x21x10
Width (mm)	10
Bearing number	MBT10
Bore Diameter (mm)	10
Outer Diameter (mm)	21
Basic dynamic load rating (C)	22,55 kN
Static load rating radial (C0)	50,01 kN