

Bearing No. 45BTM5216

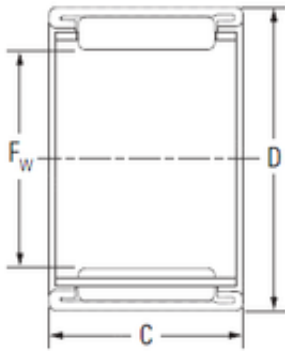

D	52 mm
C	16 mm
Fw	45 mm
Weight	0,045 Kg
Size (mm)	45x52x16
Width (mm)	16
Bearing number	45BTM5216
Bore Diameter (mm)	45
Outer Diameter (mm)	52
Basic dynamic load rating (C)	19,1 kN
Basic static load rating (C0)	41,3 kN