

Bearing No. 45BTM5220A

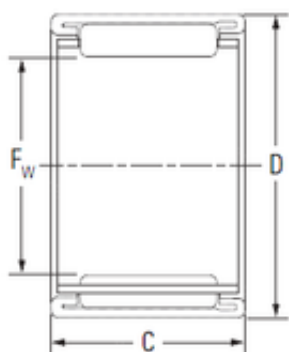

D	52 mm
C	20 mm
Fw	45 mm
Weight	0,079 Kg
Size (mm)	45x52x20
Width (mm)	20
Bearing number	45BTM5220A
Bore Diameter (mm)	45
Outer Diameter (mm)	52
Basic dynamic load rating (C)	23,3 kN
Basic static load rating (C0)	33,4 kN