

Bearing No. RCJY25-JIS

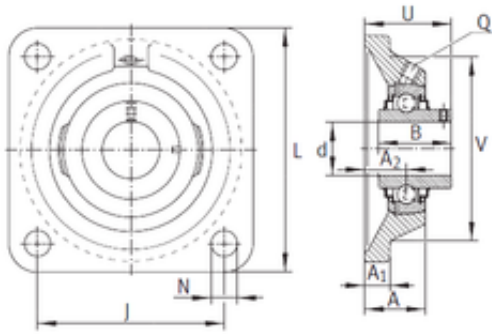

d	25 mm
U	35,8 mm
A	27 mm
B	34,1 mm
J	70 mm
L	95 mm
N	12 mm
A1	14 mm
A2	16 mm
Weight	0,76 Kg
Thread (Q)	M6
Bearing number	RCJY25-JIS
Bore Diameter (mm)	25
Basic dynamic load rating (C)	14 kN