

Bearing No. 13BTM1912

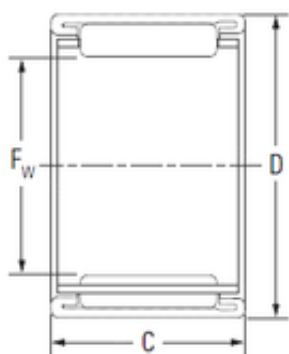

D	19 mm
C	12 mm
Fw	13 mm
Weight	0,0095 Kg
Size (mm)	13x19x12
Width (mm)	12
Bearing number	13BTM1912
Bore Diameter (mm)	13
Outer Diameter (mm)	19
Basic dynamic load rating (C)	5,85 kN
Basic static load rating (C0)	6,7 kN