

Bearing No. 9BTM1312

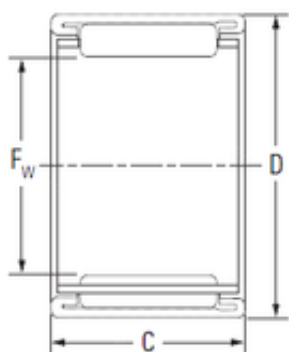

D	13 mm
C	12 mm
Fw	9 mm
Weight	0,0046 Kg
Size (mm)	9x13x12
Width (mm)	12
Bearing number	9BTM1312
Bore Diameter (mm)	9
Outer Diameter (mm)	13
Basic dynamic load rating (C)	4,2 kN
Basic static load rating (C0)	5,5 kN